

# Intelligence Made Easy



## WD 290 IQ

For efficient and fail-safe instrument reprocessing

**Belimed**  
Infection Control

## With integrated intelligence for safe reprocessing

The WD 290 IQ washer-disinfector is the intelligent solution for instrument reprocessing in your central sterile supplies department (CSSD). It is at the heart of secure, fast and efficient. With the WD 290 IQ, you achieve perfect hygienic results, keep your costs under control and unburden your staff.



### Intuitive operation

The WD 290 IQ focuses on the simple operating concept and the extensive control functions. It is easily operated by use of the two large touchscreens. The intelligent control system simplifies the processes in

your CSSD, relieves your staff of time-consuming tasks and ensures that you always achieve perfect hygienic results. The WD 290 IQ adapts to your requirements – and not vice versa.

#### Two doors – two screens

- The first washer-disinfector (WD) that can be operated from two sides
- Two large, clearly organized touchscreen panels with 10.4" display
- Independent yet simultaneous operation by CSSD employees in unclean and clean areas

#### Intelligent programs

- Preset and individual programs for optimum setting of cycle parameters
- Quick and easy creation of individual programs from function blocks
- Perfect hygienic results for every load

#### Batch release without loss of time

- Batch release directly on the touchscreen saves time and paper storage
- Subsequent retrieval of process data for in-depth visual inspection and batch evaluation
- The subsequent release allows the next cycle to be started after the end of the cycle without loss of time

#### Seamless documentation

- Storage of process data, release documentation and cycle information for up to 1,000 batches
- Display and recording of warnings and fault messages for simple and fast machine diagnosis
- Automatic service and individual validation interval notification
- Transmission of all data via USB or LAN interface

#### Detailed user administration

- Every CSSD employee sees exactly the tasks that are important to them
- Release and restriction of program selection, cycle start and batch release
- Different access levels for operators, team leaders, technicians and validators
- Authentication by PIN code or batch scan

#### Complete traceability

- Load carriers, sieves and loading units can be entered for each batch
- Capture via manual input or barcode scan
- Alternative capture of rack ID via automatic RFID transmission

# Efficient and failsafe throughout the entire process

Intelligent reprocessing begins long before the start of the WD program and is far from complete when the unloading door is opened. The operation, control and equipment options of the WD 290 IQ are coordinated in such a way that all processes from loading to release mesh seamlessly and ensure consistent processing results.

## Loading

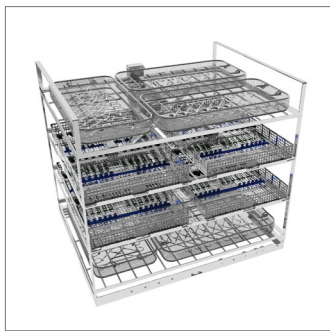

### The right load carrier for every instrument

Only if instruments are correctly fixed, stored and adapted it can be ensured that no areas are left unwashed and that lumens are flushed through correctly.

The WD 290 IQ offers a wide range of racks, sieve trays, adaption solutions and accessories to load instruments quickly, safely and easily.

## Preparation



### Zero idling – full capacity utilization

While the previous preparation cycle is still running, the next batch can already be prepared. Whether manually or with the scanner.

You can already enter the load carrier ID and the batch content while still running the previous program, thus saving valuable time.

## Start



### No waiting at the loading door

As soon as the rack is placed at the door, loading and program start are completely automatic.

The motorized rack drive automatically transports the rack into the washer chamber. Magnetic contacts detect the rack type, and the intelligent control automatically sets the correct program.

The loading door closes and the processing starts completely automatically.

## Reprocessing



### Always well informed

With the patented status display, the CSSD employee can remotely note the remaining processing time for the current preparation cycle.

This allows them to schedule their tasks accordingly in order to prepare the next batch and pass on the current batch for postprocessing without delay.

The process data is continuously monitored by the independent process control monitoring system and displayed on the two touchscreens.

## Unloading



### Unburdening your personnel

Whether completely automatic or partially manual: With the Belimed SISO and WA 290 automation solutions, you can decouple the sub-processes in instrument reprocessing and thus ensure optimum capacity utilization of your reprocessing systems during loading and unloading.

The CSSD employees are relieved of physically heavy tasks and gain flexibility and time for other activities.

After unloading, empty racks are transported back to the unclean area via the return transportation system or alternatively through the washing chamber of the WD 290 IQ.

## Approval



### Fewer errors and higher safety

After unloading, the CSSD employee can start the next preparation cycle without delay.

They carefully carry out visual inspection and batch evaluation without time constraints and perform the release directly on the WD 290 IQ screen, irrespective of the current status of the WD.

The cycle documentation is stored for up to 1,000 batches including the process protocol, the batch number, the loading information as well as any notes or error messages and can be read and archived electronically via the local LAN network or a USB stick.



## Always the most cost-effective alternative

The outstandingly low consumption makes the WD 290 IQ a true savings star. The reduced use of water, chemicals and energy takes the strain off your budget and protects the environment. With the WD 290 IQ, you choose the most cost-effective solution from planning to disposal every time.

### Up to 50 liters less water<sup>1</sup>

Water is the most important operating medium in modern washer-disinfectors. Four out of five process steps require either fresh water or fully deionized water (DI).

The Smart Fill technology reliably adjusts the fresh and DI-water quantity to the load. So you always achieve perfect hygienic results and only use as much water as you actually need.

### Minimum use of chemicals

Less water means fewer chemicals and that means significantly lower costs. The efficient cleaning agents of Belimed Protect™ make it possible: The combination of WD 290 IQ and Belimed Protect™ Mild Alkaline Cleaner offers the best cleaning results under the same conditions.<sup>2</sup>

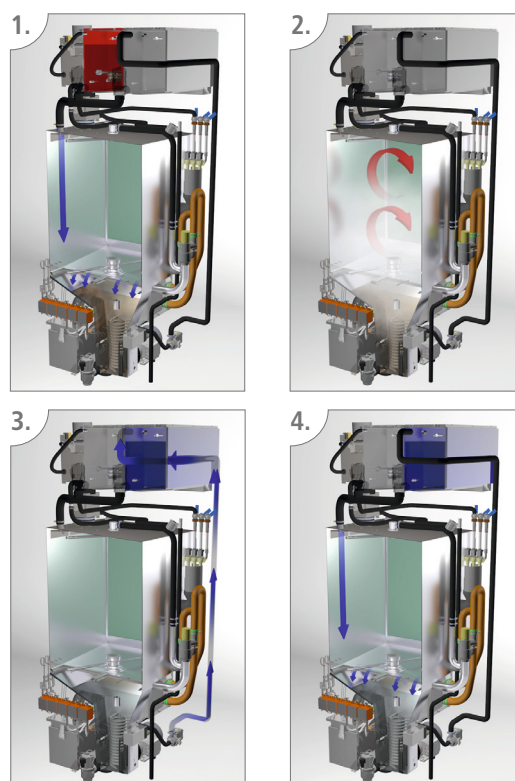
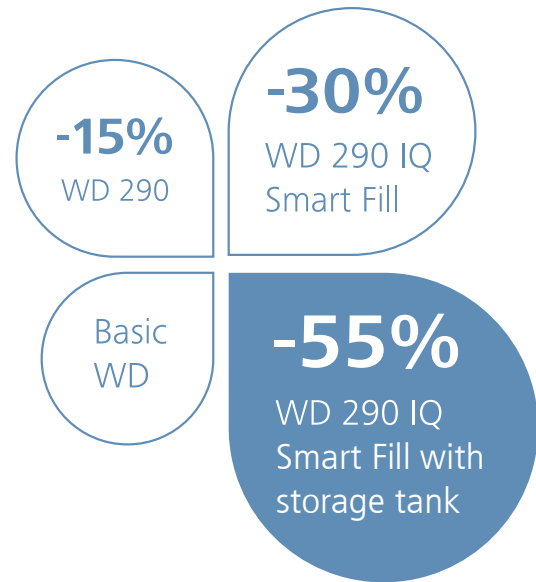

### Recycling of the DI-water

The clean and disinfected water from thermal disinfection can be stored in the storage tank and reused for rinsing in the next reprocessing cycle. In this way you save up to 40 liters of expensive DI-water per batch—reducing your costs and protecting the environment.

### Here's how it works:

1. For thermal disinfection, DI-water is poured into the washer chamber from the DI-water tank or directly via the supply line
2. Thermal disinfection
3. Drain of clean and disinfected water into the storage tank
4. Use of the process water for rinsing in the next reprocessing cycle

<sup>1</sup> In comparison with the predecessor model WD 290 for one cycle in the standard "Instruments" program

<sup>2</sup> Compared to standard process chemicals on the market

# The Belimed system solutions

The WD 290 IQ washer-disinfector is the central system for efficient reprocessing in your CSSD – the intelligent Belimed system solutions are perfectly matched to the WD 290 IQ and ensure that you always achieve the best hygienic results and benefit from high availability.

## Accessories suitable for every application

- The right load carrier for every instrument
- A wide range of racks, adapters and accessories
- Compatibility with the Belimed WD 290 and WD 390 washer-disinfectors for more flexibility

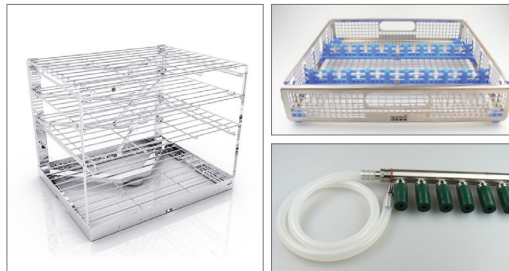

## SISO and WA 290 automation systems

- Fully automated loading and unloading
- Relieves your CSSD employees of physically demanding activities
- Ensures optimum capacity utilization
- No waiting times for your staff



## Belimed Protect™ process chemicals

- Optimum cleaning results
- Proven excellent material compatibility for lower repair costs and longer instrument service life
- Full range of detergents, disinfectants and care products



## Belimed Prevent™ services

- Maintenance and repair services by trained and experienced technicians
- Fast response times
- Maintenance contracts and lifecycle management
- High availability, minimal downtimes



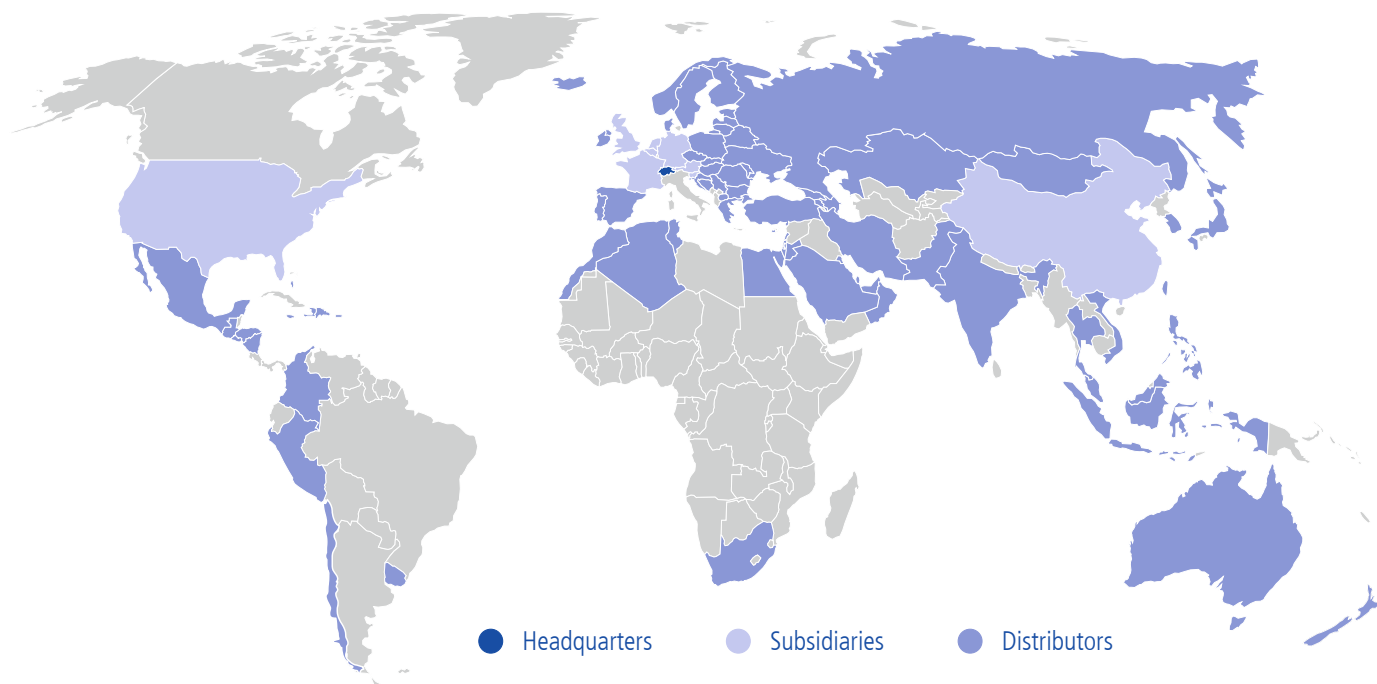

#### International headquarters

##### Switzerland

Belimed AG  
Headquarter  
Grienbachstrasse 11  
6300 Zug  
Phone +41-41-449-7888  
info@belimed.com

##### Germany

Belimed GmbH  
Edisonstraße 7a  
84453 Mühldorf am Inn  
Phone +49-8631-9896-0  
info.de@belimed.com

##### France

Belimed SAS  
Parc Espale  
1, av. Pierre Pflimlin  
68390 Sausheim  
Phone +33-3-8963-6540  
info.fr@belimed.com

##### Great Britain

Belimed Ltd.  
Unit 4, Newbuildings Place  
Dragons Green Road  
Shingley (Horsham)  
West Sussex, RH13 8GQ  
Phone+44-1403-738-811  
info.uk@belimed.com

##### Netherlands

Belimed B.V.  
Vlambloem 65  
3068 JG Rotterdam  
Phone +31-10-286-1750  
info.nl@belimed.com

##### Austria

Belimed GmbH  
Triesterstraße 238  
8073 Feldkirchen  
Phone+43-316-291129-0  
info.at@belimed.com

##### USA

Belimed, Inc.  
Corporate Office Address  
1535 Hobby Street  
Suite 103  
US-Charleston, SC 29405  
Phone +1-843-216-7424  
info.us@belimed.com

##### China

Belimed Medical Equipment  
(Shanghai) Co., Ltd.  
New Jinqiao Road #1299,  
1st Building, 2nd Floor  
201206 Pudong, Shanghai  
Phone +86-21-601-909-98  
info.cn@belimed.com

[www.belimed.com](http://www.belimed.com)

Represented by:

