



Our aim is simple:  
to create places  
that enhance  
people's lives.

Great architecture that enhances  
the built environment and enriches  
the world in which we live.

We are a talented, creative team of 80+ with a shared ambition; to work collaboratively to make healthcare better. Our knowledge and expertise is founded on over 35 years of experience and we understand the challenges and special requirements within the healthcare sector.

Our teams work nationally and internationally in every aspect of healthcare design for both the NHS and private providers. Services include architecture, interior design, estates rationalisation, masterplanning and project management.



Top: P+HS team  
Bottom: Northern Cancer Centre, Carlisle





“The team are flexible and helpful, responding quickly to project needs. They provide a consistently proactive approach to design and problem solving. They value a consultative, partnership approach and engage well with our estates, FM and clinical teams throughout each stage of design. P+HS Architects is a valued member of our supply chain and is expected to remain so for the foreseeable future.”

Image: The Endeavour Unit,  
James Cook University Hospital, Middlesbrough





# Designing outstanding healthcare

As a trusted partner in healthcare with an exemplary delivery record, we have consistently demonstrated exceptional design and technical knowledge, embedding true value into every project.

From modest refurbishments to major reconfigurations, extensions and new builds, delivering large scale new projects or complex estate rationalisations, we apply the same enthusiasm, expertise and passion for designing outstanding healthcare.

We work in all healthcare sectors: acute, primary, mental health, older age and specialist care, designing critically acclaimed schemes that deliver benefit and improve healthcare outcomes. Our desire is to create better places for people to live, work and be cared for.

## Awards

Architectural Practice of the Year  
Healthcare Estates

Project of the Year  
Building Better Healthcare

Images: top: [Houghton Primary Care Centre, Houghtonle Spring](#)  
bottom: [Nuffield Hospital, Cambridge](#)

“P+HS has always displayed a client-focused commitment which has impressed us over many projects. They are professional, approachable, extremely knowledgeable and proficient and, importantly, they worked with us rather than for us.”



## Northern Centre for Cancer Care

North Cumbria Integrated Care NHS FT (NCIC)

A new cancer centre at Cumberland's Royal Infirmary has improved access to cancer services for people across north, west and east Cumbria.

Staff were closely involved in the design using digital tools to 'walk' through the building, testing the layout and patient flows and evaluating finishes and colours. The project has created a modern therapeutic environment for patients, families and staff and brings Carlisle's cancer services together under one roof. It includes:

- two linear accelerators
- radiotherapy
- chemotherapy day unit
- CT scanner suite
- consultation and examination rooms
- café area
- complementary therapies and patient support

Known as the Northern Centre for Cancer Care, the scheme is a partnership between North Cumbria Integrated Care NHS Foundation Trust and Newcastle Hospitals and was built by contractors Graham.

Images: [Northern Centre for Cancer Care, Carlisle](#)

“when I walked into here I thought, you know what? they can really do something for me here”  
Radiotherapy patient

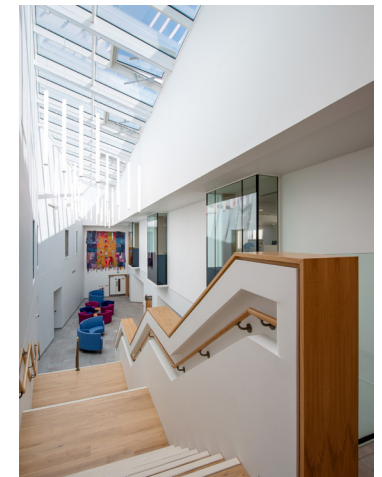



# Sir Robert Ogden Macmillan Centre

South Tees Hospitals NHS Foundation Trust

An award-winning cancer care centre designed to serve a rural community, the SROMC is a landmark building with an exceptionally supportive and uplifting environment.

We worked closely with numerous stakeholders to develop both architectural and interior design proposals. The circular design of the building wraps around a beautiful, landscaped courtyard offering continuous views to a calm and tranquil space. Materials, selected for their warm and non-clinical nature, flow seamlessly from within to outside.

Awards: Community Benefit  
RICS Yorkshire & Humber

Images: Sir Robert Ogden Macmillan Centre, Northallerton

“The building is packed with thoughtful touches that demonstrate a real empathy for users’ needs. From the stunning, welcoming reception space to the specialist treatment areas, the environment feels safe and uplifting.”



# Strategic estates planning

We bring insight and knowledge to strategic estate masterplanning.

We regularly work alongside healthcare estates and commissioning teams to unlock site opportunities and realise greater efficiencies. We understand that masterplanning begins with clinical strategy and that estates solutions must be economically viable. Complex issues surrounding phasing, access, servicing and facilities management are always considered to ensure live sites are kept operational. As part of our strategic advice, we are supported by healthcare planning, commercial knowledge and residential masterplanning expertise to assess opportunities and gain insight from multiple sources.

Our detailed knowledge of healthcare estates allows us to provide holistic and strategic advice to optimise budgets, programme and service delivery.

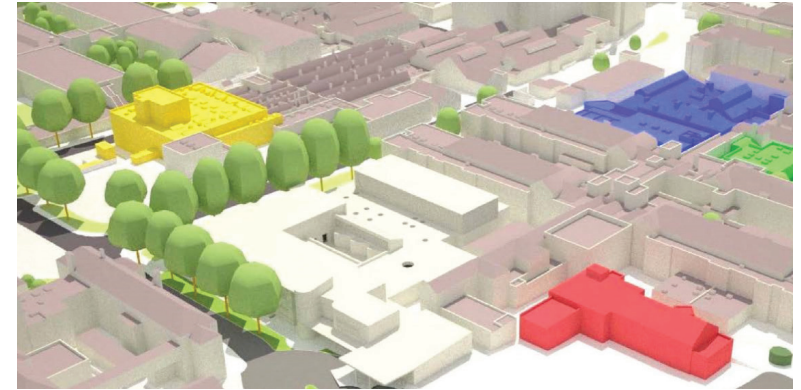

Images: top: [Nottingham City Hospital 3D site modeling](#)  
bottom: [Members of the P+HS team](#)



# Urgent and Emergency Care

North Lincolnshire & Goole NHS FT (NLaG)

We continue to work with NLaG and Kier to provide new emergency facilities at hospitals in Scunthorpe and Grimsby. The two developments have been designed to alleviate pressure on emergency amenities, reduce waiting times, streamline patient flow, and provide more rapid diagnoses.

Both schemes include new Emergency Departments complemented by bespoke Acute Assessment Units which will allow patients to be seen and treated by specialist clinicians more quickly, often without the need for hospital admission. Same day Emergency Care Assessment, Frailty, and Gynaecology services are co-located with the new EDs to provide a comprehensive and efficient Emergency Care service.

As designs were developed at the height of the pandemic, digital communication tools were used extensively.

[See an example of a work in progress walk through video of the Scunthorpe scheme here](#)

Images, clockwise from top right: visual of new ED at Scunthorpe General Hospital; completion images of new ED at Diana Princess of Wales Hospital, Grimsby

“The design development has been intense, with just 13 weeks from initial brief to the submission of a planning application. Covid restrictions, meant working remotely, using online tools to engage with staff and clinicians. We had to be flexible too, accommodating changes rapidly as the design evolved to meet the emergent client brief”

Tom Potter, Associate P+HS Architects



## Rapid response

One of the advantages of being a relatively large architectural practice is our breadth and depth of resource and ability to flex teams to respond rapidly to changing circumstances.

Never has this been more valued than in recent years, when demand from our healthcare clients was for rapid turnaround, often working within live hospital environments, reconfiguring spaces or creating new ones in response to the Covid pandemic.

From repurposing wards to creating isolation facilities, safe staff pathways or change facilities, our teams were equipped to work remotely and responsively, using technology to collaborate with clinicians and estates teams to deliver life changing, priority workflow seamlessly from within to outside.



Images, top: [Covid ward at Newcastle RVI](#)  
bottom: [Modular ward at North Middlesex Hospital](#) (courtesy Premier Modular)



# Acute Cardiology Ward

Newcastle Hospitals NHS Foundation Trust

Continuing our work with Tolent at Newcastle's Royal Victoria Infirmary (RVI), P+HS created a new purpose designed Cardiac Care Unit, improving the environment for both patients and staff.

Involving the merging of two existing wards and a complete redesign, the £2.5m scheme provides three main treatment zones: a 4-bed cardiac day unit for ambulatory patients and faster 'in/out' treatment, a 6-cubicle high dependency coronary care unit, and a 17 bed specialist coronary care ward. Two new clean utilities included in the design are equipped with Omnicell automated drug dispensaries.

The team incorporated dementia friendly principles into wayfinding and interiors using combinations of individual colour and local landmark graphics. All works were undertaken within a live hospital at the height of the pandemic, making this project an exceptional achievement.

Images: Ward 50 Cardiology, RVI, Newcastle

“The new layout of our acute cardiac unit means that we can offer heart patients significantly enhanced care and importantly, in the right place at the right time.”  
Dr Ifti Haq, Consultant Cardiologist & RVI Head of Cardiology





# Designing for wellbeing

Great healthcare environments go beyond good, well-considered, functional design. Surroundings should be easy to navigate, feel safe, and uplifting. For all our clients we aim to design places which are supportive for patients, visitors, families and the staff who provide care.

Good design helps in improving recovery rates; inspiring confidence in the service delivered and supporting staff recruitment, retention and mental wellbeing.

**“The facilities at The Friarage are truly state of the art, which ensures we can offer the best possible treatment and care to the cancer patients we look after. The staff are excited to work in this environment and feel valued.”**

**Nicky Hand, Cancer Lead  
South Tees Hospitals NHS FT**



Images, above: Sir Robert Ogden Macmillan Centre, Northallerton  
facing: St Benedict's Hospice, Sunderland





# Burleigh Medical Centre

Park Grove Medical

Serving an area of significant deprivation, this welcoming new medical centre provides increased patient capacity, extended opening hours and enhanced healthcare services. The building stands as a beacon of quality in the heart of the community and creates an outstanding environment for patients and staff.

Our role on the project included full architectural services and interior design.

The design pays homage to Barnsley's historic mining community which is reflected abstractly in the choice of materials both inside and out. Interiors are light, bright and bold with strong geometric shapes reflecting nature and the local geology. Subtle wayfinding sees colours of yellow and blue differentiating the ground and first floors.. Plants and green walls are strategically placed to enhance wellbeing.

Community was at the heart of the client's aspiration from the outset and their vision has been realised with this modern and engaging building which forms a focal point within the neighbourhood.

Images: [Burleigh Medical Centre, Barnsley](#)

“The feedback from the community has been overwhelmingly positive with patients and staff enthusing about the energy that the building has brought to the area. Staff love the spaciousness and improved working environment.”  
Dr Sumanth Chikthimmah, GP



## Durham Diagnostics and Treatment Centre

Ashley House and City Hospitals Sunderland  
Independent Commercial Enterprise Ltd (CHoICE)

“It is always a pleasure to go to the Centre; it’s bright and the staff are happy being there. The atmosphere is calm and peaceful.”

Durham’s new Diagnostic and Treatment Centre is a complex acute building that provides outpatient services in an accessible community setting, saving money for the NHS. It includes:

- reception and wait areas
- renal dialysis
- ophthalmology
- urology
- ENT
- day-case theatre
- recovery
- outpatients facilities

“This is about building for the NHS of the future in which patients won’t always have to travel to hospital for tests and treatment, and in which diagnostic and treatment centres are fit for the job they need to do.”

Wayne Carr, Director for  
City Hospitals Independent  
Commercial Enterprises Ltd



Image: Durham Diagnostic and Treatment Centre, Durham



# Day Treatment Centre

Newcastle Hospitals NHS Foundation Trust

A fast-track project developed to tackle NHS waiting lists, the new Day Treatment Centre at Newcastle's Freeman Hospital went from car park to completion in under 38 weeks.

P+HS worked full time with the client's clinical team over an intense two week period to develop the brief, prepare concept designs and establish an initial outline proposal for approval. The design team then worked with main contractor Robertson Construction, to develop the design information and allow a rapid start on site to achieve the construction timescales required.

The scheme has four theatres (two with laminar flow canopies providing ultra clean ventilation) to deliver a range of non-complex surgery and procedures including orthopaedics and urology. Designed to ensure an efficient and enhanced patient flow, the scheme also includes 14 pre-op bays, 8 first stage recovery and 16 second stage recovery bays. Staff welfare and ancillary accommodation is to the highest standards to maintain a positive environment for both staff and patients.

Images: Day Treatment Centre, Freeman Hospital, Newcastle

“I love the space, the natural light – windows we can see out of, and the storage! You can really tell that people from here were involved in the design”  
Staff member



# Designing for better mental healthcare

Mental healthcare facilities have particular challenges around safety, security and stigma. We work hard to break down barriers, bringing design ambition to every project and seeking to create non-clinical environments.

We are proactive in our work with the Design in Mental Health Network (DiMHN), a not-for-profit organisation whose aim supports our own belief: design matters.

## Awards

Architectural Practice of the Year  
Healthcare Estates

Highly Commended  
Stakeholder Engagement  
Design in Mental Health

Grand Prix Design Award  
Design in Mental Health

“An absolutely amazing facility.  
We should be proud of this.”

“The psychiatric intensive care unit which P+HS delivered was a very demanding project technically, with a mixture of new build and refurbishment with many challenges on site. The end result is a unit which the Trust is extremely proud of and which has won two national awards for the standard of its environment.”



Images, clockwise from top: Kingfisher Court, Haven Court, FitzRoy House



# Foss Park Hospital

Tees Esk & Wear Valleys NHS Foundation Trust

A new adult mental health hospital for York, Foss Park is a place of welcome and calm, where great thought has been given to creating a building that feels comfortable, safe and easy to use.

Inside there are 72 bedrooms over 4 wards - male, female and organic and functional illness of older age. Also 136 assessment; ECT; therapy spaces; gardens; gym; café; family visiting; staff areas; R&D facilities and bases for York's adult and older people's crisis teams, care home liaison and dementia teams. A spacious reception provides a light welcoming space with a volunteer run cafe and views through to one of the gardens. Single sided corridors mean bedrooms open onto light filled spaces with garden views and a seat to enjoy them from.

Engagement was exceptional; with over 60 public consultation events, interactive workshops and arts strategy groups involving service users, staff and community.

[Watch the video here](#)

Awards: Best Interior Design  
Building Better Healthcare

Images: [Foss Park Hospital, York](#)

“An acute mental health hospital is not somewhere that anyone hopes to be in, but for those who do need it in their recovery journey we now have facilities in York that the whole community can be proud of.”  
Service User



# Exceptional people, creative design, technical skill and proven experience.

We believe that we have the right knowledge and skills to help clients deliver improvements across the healthcare sector.

We are passionate about the potential to transform environments for the better through our collaborative, considered and creative approach.

Please get in touch, we'd love to work with you.



**P+HS Architects**

The Old Station  
Station Road  
Stokesley  
TS9 7AB

01642 712684

84 Albion Street  
Leeds  
LS1 6AG

0113 245 4332

Milburn House  
Dean Street  
Newcastle upon Tyne  
NE1 1LE

0191 230 8103

[enquiries@pandhs.co.uk](mailto:enquiries@pandhs.co.uk)  
[www.pandhs.co.uk](http://www.pandhs.co.uk)